

FLUID MEMBRANE

SYNTHETIC SEALING MEMBRANE FOR BRUSH AND SPRAY APPLICATION

CE
EN 1504-2
EN 14891



ELASTIC



DAMP
PROOF

FLEXIBLE

The synthetic resin mix is elastic and resistant to any movement of the sealed cracks.

FAST INSTALLATION

It can be applied using a roller, brush or spray with the possibility of inserting a synthetic reinforcing fabric.



TECHNICAL DATA

Properties	standard	value	USC units
Classification	EN 1504-2	PI-MC-IR ⁽¹⁾	-
	EN 14891	DM 01 ⁽²⁾	-
Density	ISO 2811-1	1,45 kg/L	12.10 lb/gal
Dry residue (m/m a 130 °C)	ISO 3251	65%	-
Surface cross-linking time 23 °C/50% RH ⁽³⁾	-	4 h	-
Time required for drying 23 °C/50% RH ⁽³⁾	-	24 h	-
Application temperature (product, ambient and support)	-	+5/+35 °C	+41/+95 °F
Resistance to temperature	-	-20/+90 °C	-4/+194 °F
Reaction to fire	EN 13501-1	E	-
Brookfield viscosity	EN ISO 3219	60000 ± 12000 cP	-
Material yield ⁽⁴⁾⁽⁶⁾	-	> 1,5 kg/m ²	-
Adhesion on concrete by direct traction	EN 1542	> 1 N/mm ²	145 lbf/in ²
Watertightness	EN 14891	compliant	-
Liquid water permeability (W)	EN 1062-3	< 0,1 kg/m ² ·h ^{0.5}	-
Water vapour transmission (Sd) (0,2 mm)	ISO 7783	< 5 m	> 0.7 US Perm
Carbon dioxide permeability (C)	EN 1062-6	> 50 m	-
Storage temperature ⁽⁵⁾	-	≥ +5 °C	≥ +41 °F
VOC	Dir. 2004/42/CE	2,25 % - 32,65 g/L	-

⁽¹⁾Principles. Protection against penetration risks (H,I,C); humidity control (H,C); increasing resistivity by limiting humidity content (H,C). Types. H: Hydrophobic impregnation; I: Impregnation; C: Coating.

⁽²⁾Water-based waterproofing product for liquid application in dispersion with improved crack bridging capability at -5 °C equal to: >0,75 mm.

⁽³⁾The reported values may vary depending on the applied thickness and the specific conditions of the construction site (temperature, humidity, absorbency of the substrate, ventilation).

⁽⁴⁾At least two to three coats must be applied. Average consumption may vary depending on the nature and porosity of the support and the desired thickness.

⁽⁵⁾ Store the product in a dry, covered location. Check the date of manufacturing on the packaging. It is affected by frost.

⁽⁶⁾ On surfaces larger than 10 m², apply REINFORCEMENT on the first wet layer. When applied on porous support surfaces, it is advisable to dilute the first layer up to 20% water. Wait until completely dry before applying the second layer.

Waste classification (2014/955/EU): 08 04 16.

CODES AND DIMENSIONS

CODE	content		colour		
	[kg]	[lb]			
FLUIDMEM	10	22	grey	1	24

■ FIELDS OF APPLICATION



■ PUMP SPRAY

ELECTRIC AIRLESS SPRAYER

- Speed and efficiency
- Transparent suction system

CODE	version	pcs
PUMPSPRAY240	240 V cable	1

See the product on page 390.

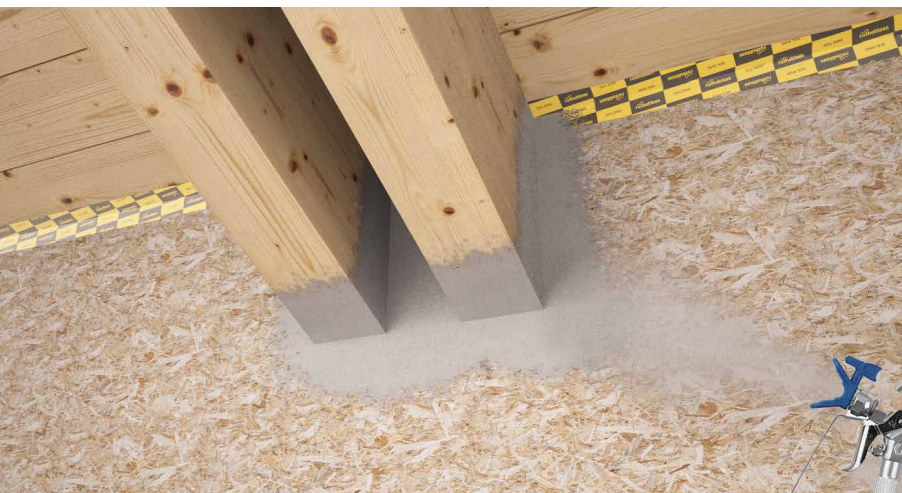

SAFETY

Resistant to water stagnation on the surface, even when there is no slope. Also suitable for surfaces in industrial areas or in sea areas. Odourless and non-toxic product. Solvent-free.

ADHERENCE

Thanks to its formulation, the product offers perfect adhesion, is suitable for complex construction details and resists micro-cracks.