

ANCHOR FOR FASTENING INSULATION TO BRICKWORK

CERTIFIED

Anchor with the CE mark in accordance with ETA, with certified resistance values. Double expansion with preassembled steel nails allows for fast versatile fastening on concrete and brickwork.

DOUBLE EXPANSION

Ø8 PVC double expansion anchor with preassembled steel nails, for fastening to concrete and brickwork. Can be used, with an additional washer, on particularly soft insulating materials.



CODES AND DIMENSIONS

CODE	d _{HEAD} [mm]	L [mm]	d _{HOLE} [mm]	A [mm]	pcs
ISULFIX8110		110		80	250
ISULFIX8150	60	150	8	120	150
ISULFIX8190		190		160	100

A = maximum fastening thickness

CODE	d _{HEAD} [mm]	description	pcs
ISULFIX90	90	additional washer for soft insulation	250

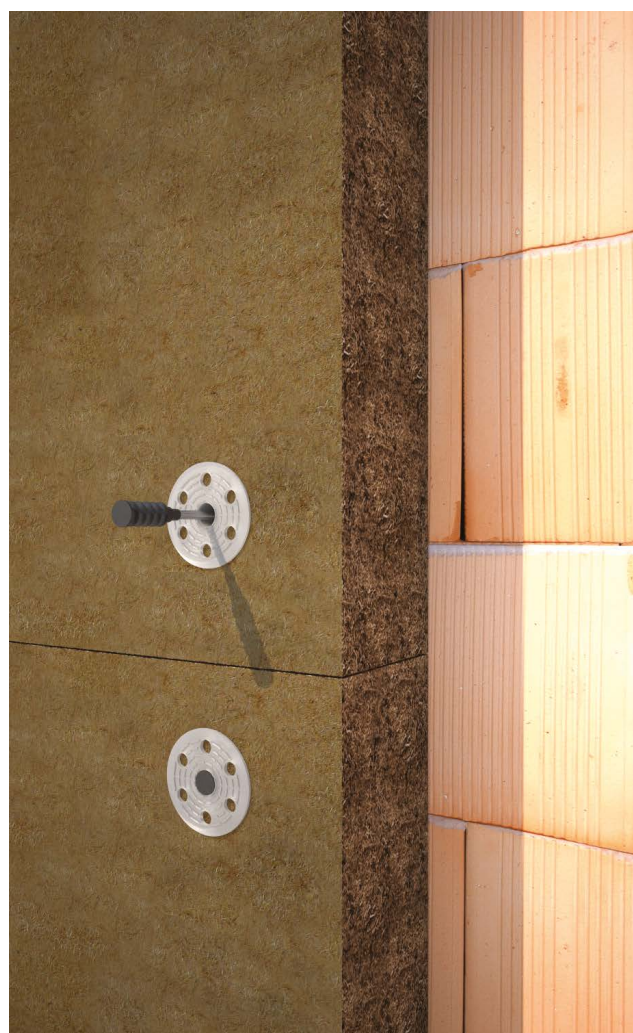

SERVICE CLASS



MATERIAL

PVC	PVC system with carbon steel nail
-----	-----------------------------------



FIELDS OF USE

Anchor available in various measurements for different insulation thicknesses; can be used with an additional washer for use with soft insulation; method of use and certified laying possibilities indicated in the relative ETA document.